

## Timber Portal Shed in Coles Bay

Location: Coles Bay, TAS  
 Builder: CBC Building Contractors  
 T&F supplier: Becks Frame & Truss (Mitre 10)  
 Products: Timber portal frames and meySPAN14 purlins/girts supplied by Meyer Timber

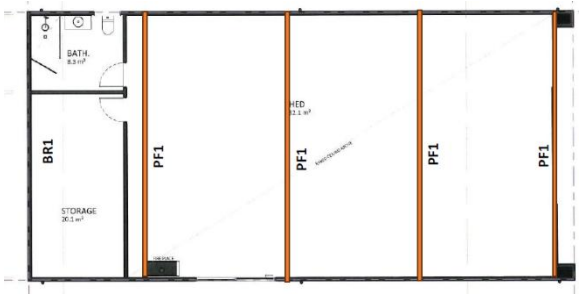

*“Delivered as flat packs, the timber portal frames were fast and easy to install.”*



Meyer Timber

Castlereagh Rd, Penrith, NSW 2750 p: (02) 4726-5900  
 Dana Court, Dandenong, Vic, 3175 p: (03) 9791-1897  
 Stephens Way, Luscombe, QLD, 4207 p: (07) 3895-2222  
[www.meyertimber.com.au](http://www.meyertimber.com.au)

